



University
of Glasgow

Nankai University -
University of Glasgow
Joint Graduate School

**POST
GRADUATE
STUDY
IN CHINA**



南開大學

Nankai University



DISCOVER OUR JOINT GRADUATE SCHOOL

Our school offers you the opportunity to experience the exciting city of Tianjin, China and to graduate in two years with postgraduate degrees from both the University of Glasgow and Nankai University.

Teaching and assessment is in English and you will benefit from the research and teaching of academics from both institutions. In short, we can offer you the best features of the UK and Chinese university systems, and a choice of subjects that draw on strengths at both institutions.

University of Glasgow

Founded in 1451, we are the fourth-oldest English-speaking university in the world. Today we are recognised for the quality of our teaching and our world changing research, which enables us to attract 26,000 students from 140 countries every year.

We are:

- ranked joint 69th in the world and were the first UK university to be rated as 5 Stars Plus overall (QS World University Rankings 2019)
- ranked joint 93rd in the world by the Times Higher World University Rankings 2019
- a member of the prestigious Russell Group of research-led UK universities.

Nankai University

Founded in 1919, Nankai is a Project 985 and Project 211 member, which means it has been selected by the Ministry of Education to receive significant investment in order to attract world leading staff and train world changing scholars. We consistently rank in the top 10 universities in China and have extensive international links with more than 290 internationally-renowned universities.

The University has two main campuses

- Balitai campus
- Jinnan campus

The City of Tianjin

Tianjin is China's fourth largest urban area by population. It has ranked first for GDP per capita among Chinese administrative divisions since 2011 - besting both Beijing and Shanghai.

Located 30 minutes from Beijing by bullet train, the city is a key part of the development of a major new urban area called Jing-jin-ji.

The new megalopolis will be home to over 15 million people and will be at the heart of the Chinese economy. Tianjin is a modern and vibrant city, yet one with a rich cultural heritage. It boasts an array of different architectural styles.

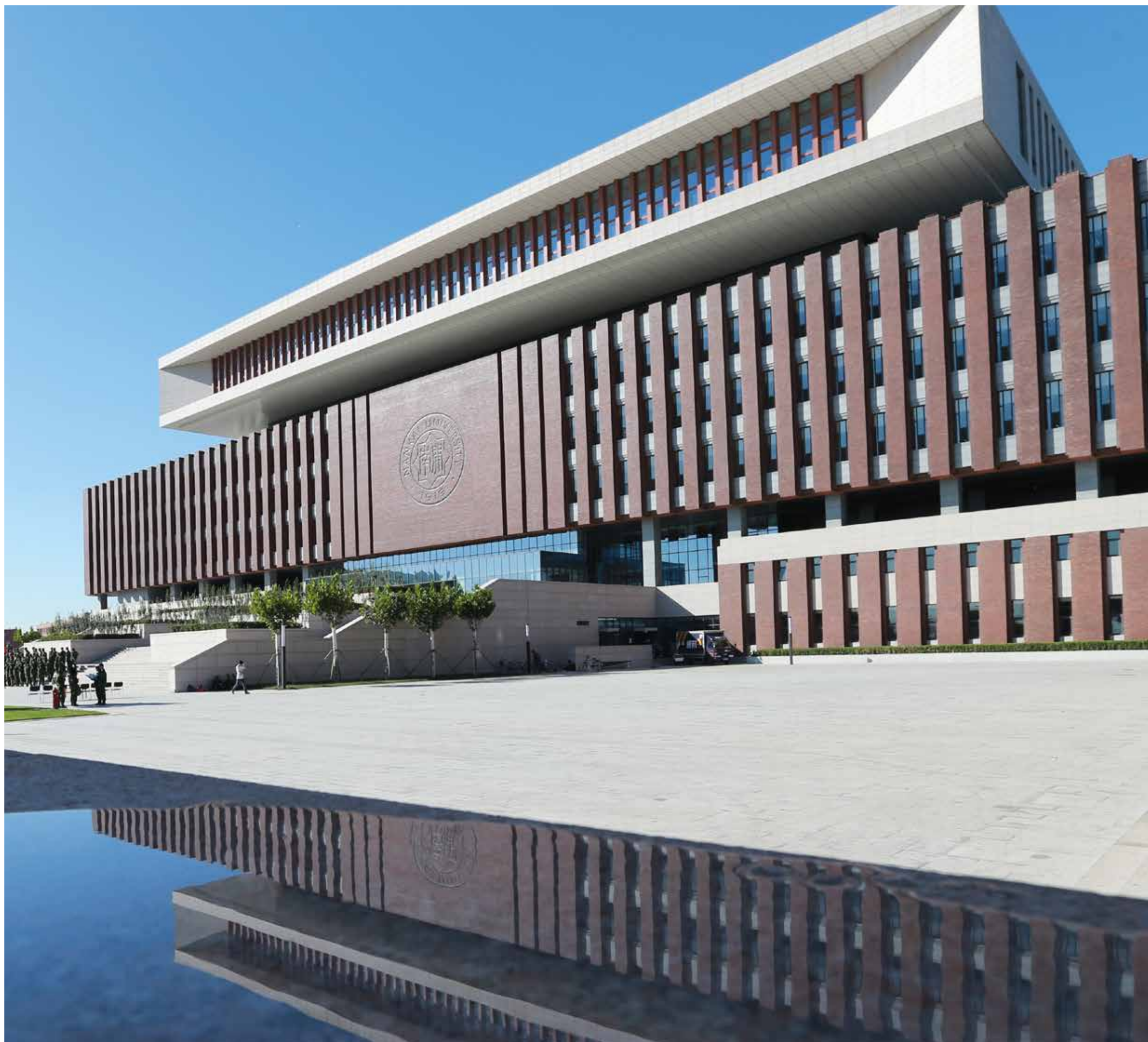

Nankai University opened a new campus in Jinan in 2016.



Ba Li Tai campus of Nankai University.



The Principal of UofG, Sir Prof Muscatelli gives speech in the first JGS Graduation.



The first graduation ceremony in 2017.

DUAL MASTERS DEGREE IN URBAN & REGIONAL PLANNING

The MSc in Urban & Regional Planning promotes a thorough understanding of how cities and regions function. As a graduate, this will allow you to make a real and positive difference to the social, environmental and economic welfare of towns, cities and regions.

Programme overview

At its core, the programme aims to promote the social scientific understanding of cities.

You will be taught to understand:

- the economic underpinnings of urban and regional development
- the processes and institutions of urban governance
- the relationships between places and urban society.

You will also learn to demonstrate the value of research-based urban analysis and understanding. In this process, you will improve your own research skills.

You will develop an understanding of cities, property markets, institutions and governance. This provides an essential foundation to effective action in the development and management of cities.

To promote effective work across professional boundaries, you will critically appreciate the roles of a range of urban professionals and other stakeholders.

You will understand the importance of research and reflection as a route to successful urban planning innovation.

Why this programme?

This degree programme equips you for a wide range of opportunities by providing the knowledge and understanding to:

- critically identify cities as dynamic spaces in the local, national and global economic and political system
- evaluate the main theories about the uniqueness of cities, their development in time and space, and their particular assets from a social, economic, cultural and environmental perspective
- contrast and compare urban trends in different regions of the world, together with the drivers of these changes

- demonstrate a sound understanding of the current urban problems faced by different professions in urban planning and management; as well as city dwellers themselves
- evaluate environmental sustainability as a concept, with particular reference to the demands and pressures cities place on the natural environment in different regions
- assess the underpinnings of urban planning theory and how it has shaped urban interventions
- critique the roles and functions of planning in cities areas with a view to shaping urban change
- compare the rationale for, and assess the effectiveness of, different forms of partnership between the public, private and voluntary sectors in implementing urban development and regeneration, and understand the political variations in the urban development processes in different countries.
- evaluate the relationship between market processes, built form, private and public realm, different development models and patterns of movement
- assess the economic and financial implications of alternative development strategies and evaluate how best to create high quality places and generate and capture added value for both particular interests and the wider community.

Programme structure

The programme is taken over two years of full-time study and includes required courses offered by both universities.

Nankai University courses may include:

- English Language training.
- Intermediate Econometrics
- Intermediate Microeconomics
- Intermediate Macroeconomics
- Regional Economics
- Regional Economic Issues in China
- Urban Economics

University of Glasgow courses may include:

- City Planning Theory and Practice
- Global Cities
- Real Estate Institutions and Markets
- Research Methods.
- Urban Design and Development

You will also be required to submit a dissertation.

Career prospects

Graduates will find that opportunities exist in planning and development agencies, consultancies, property developers, local and regional authorities, regeneration and development agencies and government; and further study at PhD level.

DUAL MASTERS DEGREE IN ENVIRONMENTAL SCIENCE

The MSc in Environmental Science draws on expertise in the College of Environmental Science and Engineering at NKU and the school of Interdisciplinary Studies and Geographical & Earth Sciences at the University of Glasgow. Together they represent a leading centre of expertise in environmental teaching and research. They work on issues dealing with the natural and urban environment including policies and practices for environmental science.

Programme overview

The MSc in Environmental Science aims to produce graduates who

- have a strong understanding of the environment and how it changes
- have an awareness of economic and policy issues affecting the environment
- are able to apply practical and technical solutions to assist in the management of the environment, environmental risk and environmental change.

You will develop a firm understanding of the environment and how human and physical processes affect it.

You will be introduced to theories and practices for environmental science, as they are applied in a range of environments and at different scales. You will develop skills in processing and presenting environmental information to inform and enhance a broad range of environmental problems.

You will gain an enhanced appreciation of the importance of research and reflection to provide scientifically based solutions to environmental problems.

Why this programme?

This degree programme equips you for a wide range of opportunities by providing the knowledge and understanding to:

- critically assess the influence of physical processes and the impact of human decision making on the environment
- evaluate theories of environmental science
- discuss theories of climate change, how this will affect different environments

- compare and contrast environmental management policies in different regions and at different scales
- discuss strategies for developing behavioural change to improve management of the environment
- create plans to react to and manage environmental change
- explain how GIS and Remote Sensing contribute to the management of environmental data and can contribute to addressing environmental problems.

Programme structure

The programme is taken over two years of full-time study and includes required courses offered by both universities.

Nankai University courses may include:

- Advances in Environmental Analytical Chemistry
- Advances in Environmental Impacts Assessment
- Eco-hydrology
- Ecotoxicology and Environmental Risk Assessment
- Environmental Engineering
- Environmental Management

University of Glasgow courses may include:

- Environmental Ethics and Behavioral Change
- Environmental Remote Sensing
- GIS for Environmental Science
- Research Methods
- Understanding Environmental Change

You will also be required to submit a dissertation.

Career prospects

Career opportunities include positions in international organisations, government ministries, academia and research institutions, non-governmental organisations, and further study at PhD level.



Student performance activities take place annually.

DUAL MASTERS DEGREE IN INTERNATIONAL RELATIONS

The MSc in International Relations provides a rigorous grounding in the study of international relations, politics, and development. It will equip you with the knowledge of methodologies appropriate to such study.

Programme overview

Drawing on a range of different disciplinary approaches – from political science, international relations, area studies, and economic and social history – the MSc in International Relations will survey the major contemporary challenges in world politics. In particular, it will focus on relations between state and non-state actors in the context of a globalised and interdependent world. The programme will also provide research training that will encompass both research skills and methodologies.

The programme provides you with

- a comprehensive programme of study reflecting a broad picture of global politics in the 21st century
- opportunities to reflect on theoretical and conceptual approaches to global politics
- knowledge of a range of relevant disciplinary and interdisciplinary approaches to the study of world politics derived from the social sciences and humanities

Why this programme?

As a graduate you will possess the knowledge and understanding to:

- demonstrate a thorough knowledge of theoretical approaches and debates in politics, international relations, and development studies
- demonstrate broad and informed knowledge of central issues in international politics such as the legitimacy of the world trading system, new ways of conceptualizing security and challenges to traditional understandings of state sovereignty
- conceptually locate rival approaches to studying international relations, politics, and development within a broader set of debates in social sciences and humanities
- demonstrate understanding of different approaches to international relations as they bear on specific domains of interest.

Programme structure

The programme is taken over two years of full-time study and courses are delivered by both universities.

Possible Nankai University delivered courses may include:

- Challenges in International Politics
- China's Foreign Policy
- International Conflict and Negotiation
- International Law.
- International Organisation
- Institutions and Policies of the EU
- International Political Economy
- US Foreign Policy

Possible University of Glasgow delivered courses may include:

- Challenges in International Politics
- Comparative European Politics
- EU in International Politics and Development
- Globalisation in the Modern Economy
- International Relations Theory
- Russian Foreign Policy
- The Geopolitics of Central Europe.

You will also be required to submit a dissertation. This focused piece of work will permit you to develop your own ideas and demonstrate your capacity for original thought; while also building on the themes and issues covered in the full range of courses.

Career prospects

Career opportunities include positions in higher education, government/foreign ministry, intergovernmental organisations, non-governmental organisations, think tanks; and further study at PhD level.



The student activity and sports centre.

DUAL MASTERS DEGREE IN TRANSLATION STUDIES

This programme is designed for Chinese speaking students looking to translate from English into Chinese and provides an excellent platform to become a professional interpreter or translator.

Programme overview

Driven by a new global economy, the last decade has seen a massive growth in demand for expert translators in China. The MSc in Translation Studies was developed in light of the increasing need for highly skilled and specialist translators globally and across a wide range of industries. As well as practical advanced translation classes, the MSc includes the Translation Studies in Theory and Practice course, presenting you with a broad overview of translation theory, history and methodology. This programme offers an excellent platform to begin a career as a professional translator, whilst providing an essential theoretical foundation for students who wish to carry out research in Translation Studies at doctoral level.

This programme aims to

- encourage the acquisition of specific linguistic skills necessary for professional-level translation from English into Chinese
- explore and examine translation methodologies and practices
- survey and assess the use of resources appropriate to professional translation, whether print, software or internet-based; and
- locate translation as a professional activity in its cultural, political, legal and business context.

Why this programme?

The programme trains students to be expert translators and interpreters who adhere to the highest professional standards and who are culturally and ethically aware.

The programme further aims to:

- provide you with both practical skills and theoretical knowledge
- improve your knowledge of both Chinese and Anglophone cultures and languages
- develop competencies that will allow you to work for language service providers, international businesses, cross-cultural companies and governmental organisations

- develop skills to translate a broad range of texts between Chinese and English, including literature, journalistic texts, technical materials, and academic articles; and develop an expertise in interpreting for audiences of international conferences and other cross-cultural and international events
- balance translation studies theory with practical translation work, meaning you will develop both academic and professional skills, preparing you for the translation profession or PhD research in the field.

Programme structure

This programme is taken over two years of full-time study and includes core courses offered by both universities.

Nankai University courses may include:

- Advanced sight interpreting
- Consecutive interpreting in theory and practice
- Mandarin advanced translation and language study
- Literary and cultural translation
- Simultaneous interpreting
- Translation of commerce, laws and diplomacy.

University of Glasgow courses may include:

- Approaches to translation and the professional environment
- Research methods in Translation Studies
- Translation Studies in theory and practice
- Translation technology: terminology management and subtitling.

You will also be required to submit a dissertation.

Career prospects

This programme caters to China's increasing demand for highly skilled and specialist translators and interpreters across a wide range of industries and on an international level.

You will acquire skills relevant to a variety of careers that may involve translation or require advanced language and communication skills.

These include:

- marketing and public relations
- careers in writing, including publishing, journalism or technical writing
- language teaching
- international commerce
- government work
- the creative industries, including TV, film, theatre.



PROGRAMME FACTS

Start date

Mid-September

Duration

2 years full-time

Location:

Nankai University, Tianjin city, China.

Teaching language:

English

Tuition fees:

RMB50,000 per year

Degree:

UofG MSc degree and NKU Masters degree

Applications open:

1 January

Applications deadline:

30 May

Application fee:

RMB600

ENTRY REQUIREMENTS

Entry requirements (for all degree programmes except Translation Studies)

1. Non-Chinese citizens who hold valid passport and above the age of 18
2. Successful completion of an undergraduate degree or equivalent with good grades.
3. English language requirements
 - I. Unconditional offer
IELTS: 6.5 with 6.0 in each band
PTE Academic: 60, no sub-test less than 59
IBT TOEFL: 92, no sub-test less than 20
 - II. Unconditional offer, subject to students completing an 8-week pre-sessional English course
IELTS: 6 with 5.5 in each band
PTE Academic: 54
IBT TOEFL: 80, with 20 in writing

Entry requirements for Translation Studies

1. Non-Chinese citizens who hold valid passport and above the age of 18
2. Successful completion of an undergraduate degree or equivalent with good grade.
3. Chinese language requirement: HSK 6
4. English language requirements
 - I. Unconditional offer
IELTS: 6.5 with 7.0 in writing
PTE Academic: 70
IBT TOEFL: 102, no sub-test less than 27
Cambridge English: Proficiency (CPE): A(=200)
 - II. Unconditional offer, subject to students completing a 4-week pre-sessional English course
IELTS: 6.5 with 6.5 in writing
PTE Academic: 68
IBT TOEFL: 100, no sub-test less than 24
Cambridge English: Proficiency (CPE): A(=191)

Required documents

1. Nankai University Application Form. Please register at **nankai.17gz.org** to fill out online application, then submit the application and print out “Nankai University Application Form”.
2. Notarised highest diploma. Prospective diploma recipients must submit official document issued by your current school to prove your current student status or expected graduation

date. If you are already employed, you should also provide documents of being on-post employees. Documents in languages other than Chinese or English must be attached with notarised Chinese or English translations.

3. Academic transcripts (written in Chinese or English).
Transcripts in languages other than Chinese or English must be attached with notarised Chinese or English translations.
4. Personal Statement, including study or research plan, personal background, financial situation, personal strengths etc., written in Chinese or English (no less than 800 words).
5. Two letters of recommendation in Chinese or English from professors or associate professors. The contact information of the recommenders should be attached.
6. Non-native English speaker should provide English proficiency test score including TOEFL, IELTS, Pearson etc;
7. Foreigner Physical Examination Form (photocopy) (written in English, can be downloaded from www.csc.edu.cn/laihua or www.campuschina.org). The physical examinations must cover all of the items listed in the Foreigner Physical Examination Form. Incomplete forms or forms without the signature of the attending physician, or the official stamp of the hospital, or a sealed photograph of the applicant are considered as invalid. Please carefully plan your physical examination schedule as the result is valid for only 6 months.
8. Photocopy of passport.
9. Copy of application fee receipt. Application fee for postgraduate is CNY600 or US\$100. Please submit the fee to the Nankai University Registry (the ground floor of Nankai University Student Activity Centre). If you need to wire the money, please send it to following account:

RMB account

Account Name: Nankai University
Bank Name: Bank of Communications, Tianjin Branch,
Nankai University (Sub-Branch)
SWT NUM: COMMCNSHTJN
Account No: 120066032010149600156

USD account

Account Name: Nankai University
Bank Name: Bank of Communications, Tianjin Branch,
Nankai University (Sub-Branch)
SWT NUM: COMMCNSHTJN
USD Account No: 120066032146300000768

Note: When submitting the payment, please clearly state that these are “graduate application fees” as well as the name and nationality of the applicant. Also, please note that this application fee is non-refundable. Whether admitted or not, the above applicant materials will not be returned.

Admission evaluation

Initial screening: The admission committee of the NKU and UofG selects qualified candidates based on their application materials.

Interview: Applicants will be invited for an online, phone or face to face interview. Interviews will be conducted in English, and exact dates will be announced in due course.

Admission: An official admission notice will be sent to the admitted candidates by the end of June.

Scholarships

Scholarships from the Chinese Government, Tianjin Municipal Government and Nankai University are available to international students. For more information, please visit the websites: www.csc.edu.cn, study.nankai.edu.cn, and check the application requirements.



‘Studying in the JGS is unforgettable experience of my life. The thoughts of collision and the cultures of interaction were flooded in my memory and equipped to my future.’
Jingwen Chen studies International Relations



‘At the JGS, we learn from each other and improve ourselves together. I have been very happy here because we work together enthusiastically like friends, and the teachers are very warm-hearted too’
Yanyu Zhou studies
Environmental Science



‘My academic interests flourish in the joint graduate school. Thanks for the great help by my teachers and school mates.’
Dingkun Lu studies
Urban Planning



‘Becoming a JGS student is a milestone in my life. Though study is hard, once you overcome the challenges, a promising future is waiting for you.’
Duanyi Yi studies Translation Studies



CONNECT WITH US

Nankai University:

International Students Office
Office for International Academic Exchanges
Nankai University
94 Weijin Road, Tianjin, P.R.china 300071

Tel: +86 22 23508825/8686/9646

studyinnankai@nankai.edu.cn

study.nankai.edu.cn

University of Glasgow:



student.recruitment@glasgow.ac.uk

glasgow.ac.uk/study/nankai

en.nankai.edu.cn